

## Basic Information

### Description

This schematic shows a typical layout of a multi compressor system controlled by the ES 6, machines are connected to the ES 6 via both the CAN network and through digital I/O (volt free contacts).

### ES 6 – Installation Possibilities

A maximum of 6 machines can be controlled by the ES 6, 1 of which can be a VSD. Pressure is measured downstream of all equipment using a transmitter. As standard, up to 5 machines can be controlled via digital I/O. Remote system start/stop is also provided as standard.

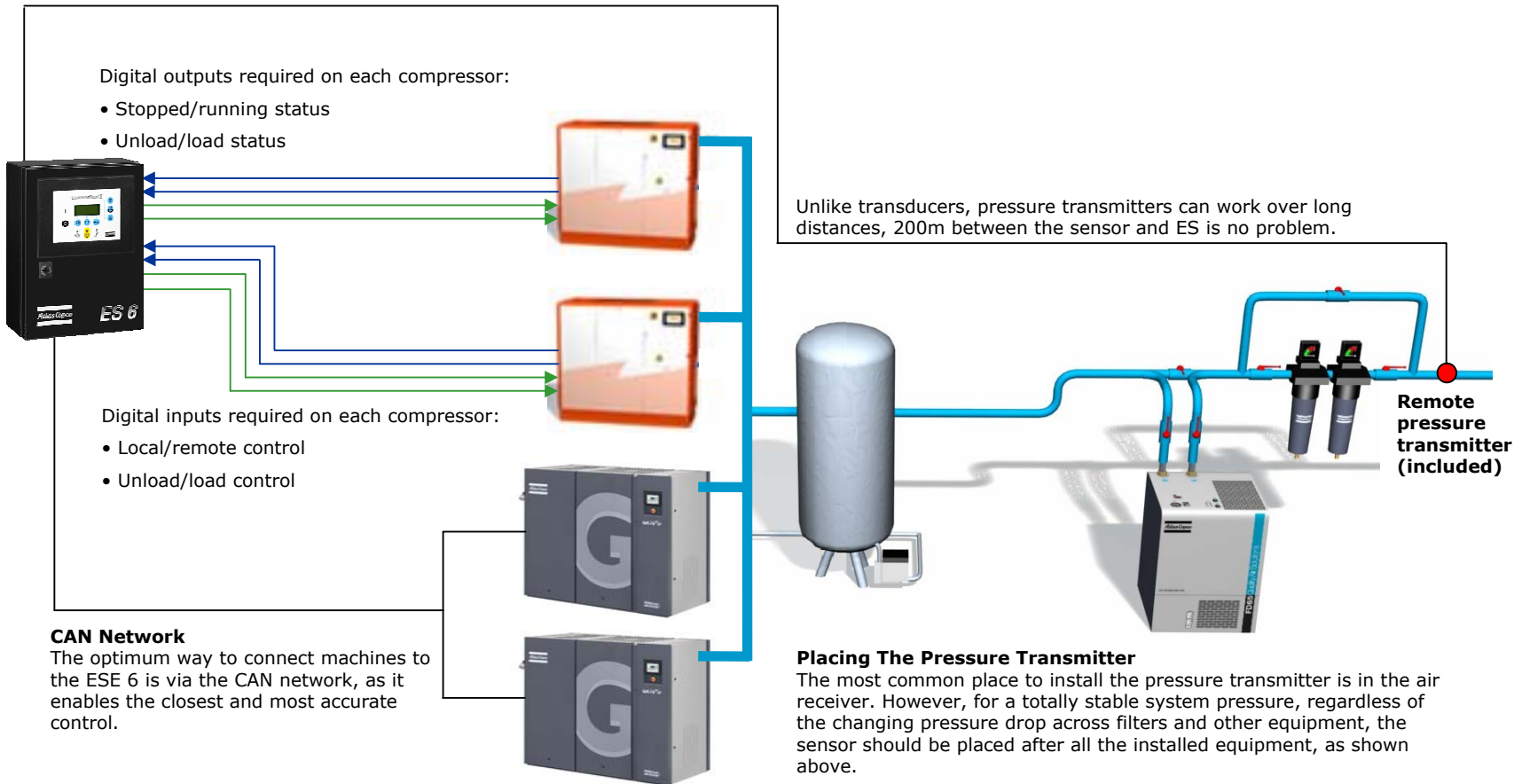

## Basic Information

### Description

This schematic shows a typical layout of a multi compressor system controlled by the ES 6, machines are connected to the ES 6 via both the CAN network and through digital I/O (voltage free contacts).

### ES 6 – Installation Possibilities

A maximum of 6 machines can be controlled by the ES 6, 1 of which can be a VSD. Pressure is measured downstream of all equipment using a transmitter. As standard, up to 5 machines can be controlled via digital I/O. Remote system start/stop is also provided as standard.

